

# HOSES & LANCES

40,000 PSI



## HOSES

### Product Description

- General purpose hoses are used to distribute high pressure water throughout the system.
- Safety whips are six foot hoses that are connected between a waterblast control gun and the rest of the hoses and are intended for periodic replacement to ensure that the hose near the gun operator's body is always in good condition
- Hydro-Throttle hoses are connected from the fluid end to the hydraulic throttle control
- For special lengths, end fittings, or cover options, see custom order instructions on page C-3
- See chart on page C-5 for information on pressure drop through hoses



Part Number	End Fitting Connection*	Length		Inside Diameter		Max. Operating Pressure		Minimum Bend Radius		Use	Cover Type*
		ft	m	in	mm	psi	bar	in	mm		
27731-02539391	9/16" Type "M" Female	25	7.6	.20	5	40,600	2,800	8.7	220	General Purpose Hoses	Abrasion Cover
27731-05039391	9/16" Type "M" Female	50	15.2	.20	5	40,600	2,800	8.7	220		
27626-02541411	7/8" Type "M" Female	25	7.6	.32	8	40,000	2,758	11.8	300		
27626-05041411	7/8" Type "M" Female	50	15.2	.32	8	40,000	2,758	11.8	300		
27626-02533331	9/16" HP Male	25	7.6	.32	8	40,000	2,758	11.8	300		
27626-05033331	9/16" HP Male	50	15.2	.32	8	40,000	2,758	11.8	300		
27524-02541411	7/8" Type "M" Female	25	7.6	.32	8	36,250	2,500	10.3	260		
27524-05041411	7/8" Type "M" Female	50	15.2	.32	8	36,250	2,500	10.3	260		
28612-02541411	7/8" Type "M" Female	25	7.6	.32	8	40,580	2,799	9.8	250		
28612-05041411	7/8" Type "M" Female	50	15.2	.32	8	40,580	2,799	9.8	250		
28612-02533331	9/16" HP Male	25	7.6	.32	8	40,580	2,799	9.8	250		
28612-05033331	9/16" HP Male	50	15.2	.32	8	40,580	2,799	9.8	250		
27731-00639392	9/16" Type "M" Female	6	1.8	.20	5	40,600	2,800	8.7	220	Safety Whips	Burst Shield Guard
27626-00641412	7/8" Type "M" Female	6	1.8	.32	8	40,580	2,799	9.8	250		
27524-00641412	7/8" Type "M" Female	6	1.8	.32	8	36,250	2,500	10.3	260		
27731-00639392	9/16" Type "M" Female	6	1.8	.20	5	40,600	2,800	8.7	220	Hydro-Throttle	Burst Shield

\* See Page C-4 for end fitting dimensions and cover descriptions. See Pages H-3 to H-5 for a description of each connection type.

### HOSE CHECKS

Manufactured from high tensile galvanized wire rope, Hose Checks are installed on hose ends to prevent injury by restraining the hose in the event of an end fitting failure. Spring-retained for easy removal. Fits all 40,000 psi hoses.

**Part Number 52242**

### Related Items

**FITTINGS** – See Fittings, Section E

**SAFETY SHROUDS**– See Safety, Page F-4

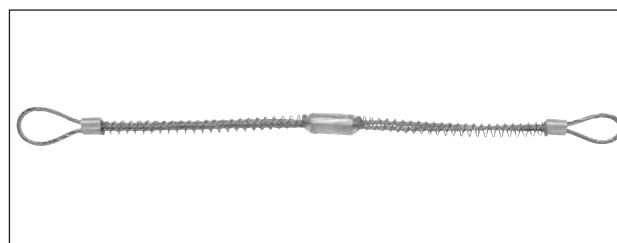

# HOSES & LANCES

40,000 PSI



## FLEX LANCES

### Product Description

Flex Lances are uncovered flexible hoses used for the cleaning of small diameter tubes such as those found in:

- Heat exchangers
- Condensers
- Boilers

Generally, they are connected to a tube nozzle with rearward facing waterjets that pull the lance through a tube, even around moderate bends, to allow efficient, powerful cleaning of otherwise impossible to reach tube walls.

Flex Lances made to special lengths or with end fitting combinations different from those in chart below can be ordered on page C-3. See chart on page C-5 for information on pressure drop through flex lances.

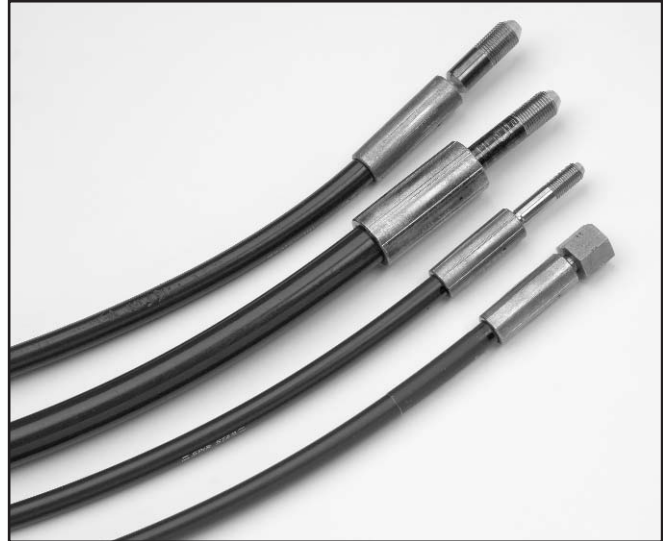

Part Number	End Fitting Connection (Inlet Side)*	End Fitting Connection (Nozzle Side)*	Length		Inside Diameter		Max. Outside Diameter**		Max. Operating Pressure		Minimum Bend Radius	
			ft	m	in	mm	in	mm	psi	bar	in	mm
28460-0253239	9/16" Type "M" Female	3/8" HP Male	25	7.6	.16	4	.66	16.8	40,510	2,794	6.9	175
28460-0353239	9/16" Type "M" Female	3/8" HP Male	35	10.7	.16	4	.66	16.8	40,510	2,794	6.9	175
28460-0503239	9/16" Type "M" Female	3/8" HP Male	50	15.2	.16	4	.66	16.8	40,510	2,794	6.9	175
28460-0253232	3/8" HP Male	3/8" HP Male	25	7.6	.16	4	.66	16.8	40,510	2,794	6.9	175
28460-0353232	3/8" HP Male	3/8" HP Male	35	10.7	.16	4	.66	16.8	40,510	2,794	6.9	175
28460-0503232	3/8" HP Male	3/8" HP Male	50	15.2	.16	4	.66	16.8	40,510	2,794	6.9	175
27731-0253339	9/16" Type "M" Female	9/16" HP Male	25	7.6	.20	5	.73	18.5	40,600	2,800	8.7	220
27731-0353339	9/16" Type "M" Female	9/16" HP Male	35	10.7	.20	5	.73	18.5	40,600	2,800	8.7	220
27731-0503339	9/16" Type "M" Female	9/16" HP Male	50	15.2	.20	5	.73	18.5	40,600	2,800	8.7	220
27731-0253333	9/16" HP Male	9/16" HP Male	25	7.6	.20	5	.73	18.5	40,600	2,800	8.7	220
27731-0353333	9/16" HP Male	9/16" HP Male	35	10.7	.20	5	.73	18.5	40,600	2,800	8.7	220
27731-0503333	9/16" HP Male	9/16" HP Male	50	15.2	.20	5	.73	18.5	40,600	2,800	8.7	220

\* See Pages H-3 to H-5 for a description of each connection type. \*\* Sleeve O.D.

### LANCE SAFETY GRIP

The Lance Safety Grip prevents the risk of a nozzle unexpectedly exiting a tube by providing a stop through which the sleeve of the flex lance will not pass. Includes lance stop retainer for use on tubes up to 3/4" OD.

Choose lance stop (not included) below.

Part Number 51024

### Lance Stops

51044 Stop for 4 mm flex lance

51779 Stop for 5 mm flex lance

### Additional Lance Stop Retainers

51425 Stop Retainer for tubes up to 1" OD.

51427 Stop Retainer for tubes up to 2" OD.

### Related Items

**SLIMLINE COUPLINGS** – See Fittings, Page E-14

**UHPE NOZZLES** – See Nozzles, Pages D-6 & 7

**DCF-40 FOOT GUN** – See Control Guns & Valves, Page B-12

**STINGERS (14" NIPPLES)** – See High Pressure Nipples in Fittings, Page E-11

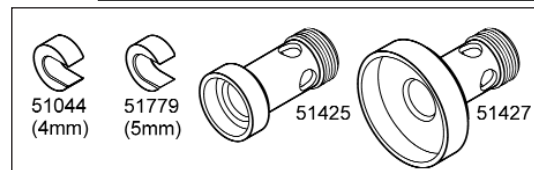
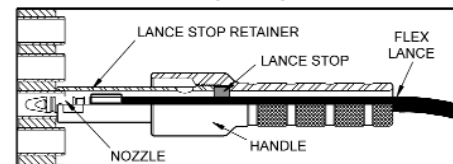

# HOSES & LANCES

40,000 PSI



## HOSES & FLEX LANCES CUSTOM ORDER

All Jetstream 40,000 psi Hoses and Flex Lances are available in custom lengths or with specially selected end fittings or covers. To order, refer to the chart and instructions below.

Common hoses and flex lance configurations are available on the two preceding pages.

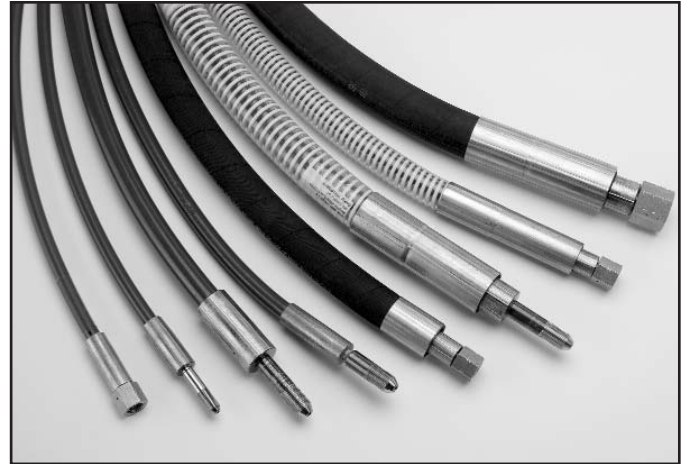

Series Number	Jacket Color	Inner Diameter		Outside Diameter*		Max. Working Pressure		Minimum Burst Pressure		Minimum Bend Radius		Weight	
		in	mm	in	mm	psi	bar	psi	bar	in	mm	lbs/ft	kg/m
28460	Purple	0.16	4	0.45	11.5	40,510	2,794	101,500	7,000	6.90	175	0.245	0.365
27731	Purple	0.20	5	0.54	13.7	40,600	2,800	101,527	7,002	8.70	220	0.330	0.500
28612	Blue	0.32	8	0.76	19.0	40,580	2,799	101,450	6,997	9.84	250	0.740	1.10
27626	Purple	0.32	8	0.76	19.0	40,000	2,758	100,000	6,897	11.80	300	0.750	1.12
27524	Orange	0.32	8	0.70	17.8	36,250	2,500	90,600	6,248	10.25	260	0.558	0.830

\* See End Fittings page in this section for maximum O.D. dimension.

## HOW TO ORDER JETSTREAM HOSES & FLEX LANCES

When ordering online, do not insert spaces between portions of the part number.

For example, a 5 mm hose, 25' long with a 9/16" Type "M" end fitting on one end, 3/8" High Pressure Male on the other end, and an abrasion guard would be ordered as 27731-02539321.

- Specify **Series Number** from chart above **28460 – AAA BB CC X**  
Insert dash after Series Number
- Specify desired **Length** in Feet (000 – 999) \_\_\_\_\_  
Example: 050 for a 50 ft. long hose
- Specify **End Fitting Codes** (BB & CC) \_\_\_\_\_  
See page C-4 for End Fitting dimensions.  
All End Fittings are stainless steel. For a hose or lance requiring two different end fittings, list the codes in numerical order when creating the part number.

### End Fitting Codes\*

Connection Size & Type	Fitting Code	Hose ID (mm)		
		4mm	5mm	8mm
1/4" HP Male	31	●	●	
3/8" HP Male	32	●	●	
9/16" HP Male	33		●	●
9/16" Type "M" Female	39	●	●	
7/8" Type "M" Female	41			●
1 1/8" Type "M" Female	43			●

● Available \* See Pages H-3 to H-5 for a description of each connection type.

- Specify **Cover Options Code** (X)  
Leave blank if no cover is desired.

### Cover Option Codes

1 – Abrasion Cover Guard

2 – Burst Shield Guard

See page C-4 for cover descriptions.

# HOSES & LANCES

40,000 PSI



## END FITTINGS

### HIGH PRESSURE

Hose Series	Size	L	Sleeve OD (D)	Wear Guard Diameter	Guard Sleeve Diameter
28460	1/4"	3.31	.66	.98	.95
	3/8"	3.34	.66	.98	.95
27731	1/4"	3.43	.73	1.00	1.07
	3/8"	3.90	.73	1.00	1.07
	9/16"	3.90	.73	1.00	1.07
27524	3/8"	3.78	.96	1.27	1.34
	9/16"	4.25	.96	1.27	1.34
27626	3/8"	3.78	1.09	1.40	1.47
	9/16"	4.25	1.09	1.40	1.47
28612	9/16"	5.13	1.10	1.27	1.49

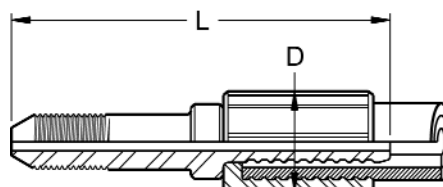

### TYPE "M"

Hose Series	Size	L	Hex Size (H)	Wear Guard Diameter	Guard Sleeve Diameter
28460	9/16"	2.50	.75	.98	.95
27731	9/16"	2.96	.88	1.00	1.07
27524	7/8"	3.65	1.19	1.27	1.34
27626	7/8"	3.65	1.19	1.40	1.47
28612	7/8"	4.43	1.25	1.27	1.49

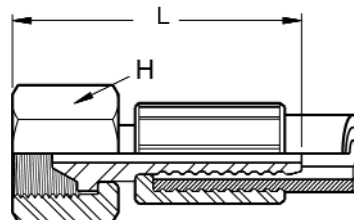

## HOSE COVER OPTIONS

### ABRASION COVER GUARD

Constructed of a clear PVC or heavy-duty vinyl and reinforced with a rigid helix coil. The Abrasion Cover Guard helps protect the hose from excessive wear due to scuffing or rough surfaces, and also provides additional protection from external objects.



### BURST SHIELD/GUARD

Constructed of steel wire reinforced heavy-duty synthetic rubber. The Burst Shield/Guard helps protect the user and/or surrounding areas from hose failures.



# HOSES & LANCES

40,000 PSI



## HOSE & FLEX LANCE PRESSURE DROP DATA

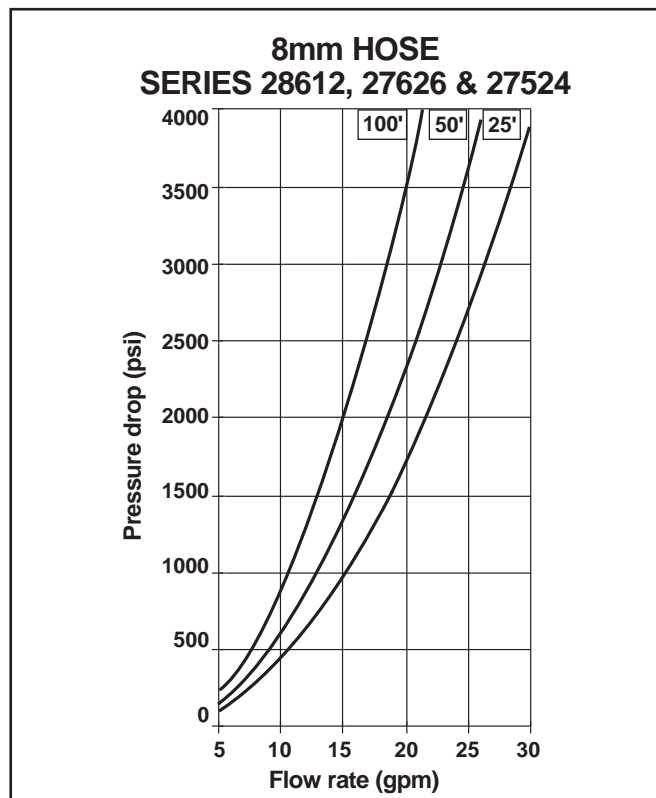
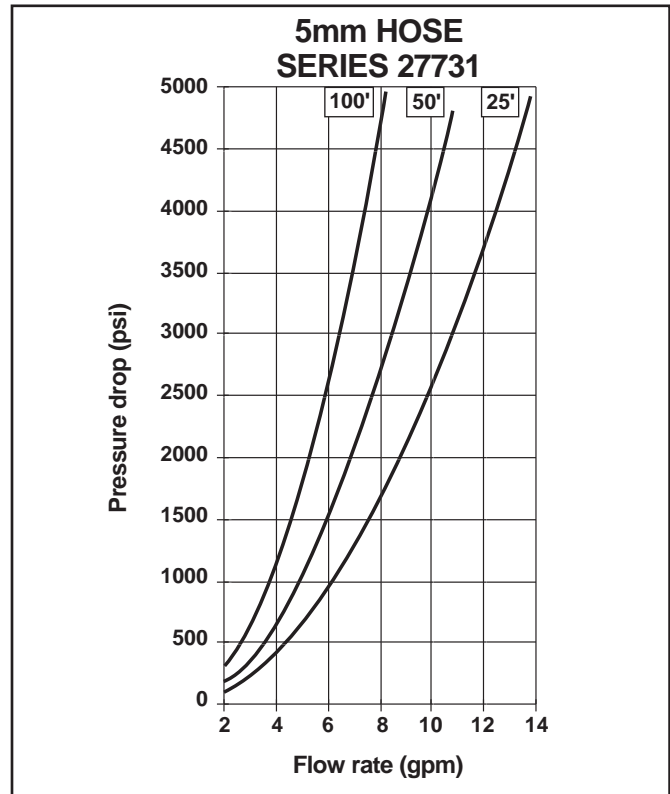
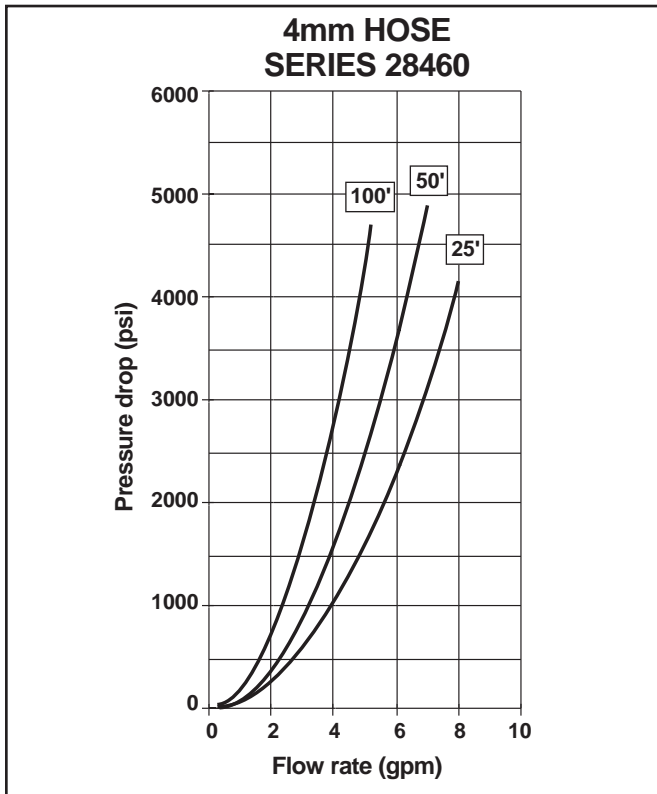

# HOSES & LANCES

40,000/60,000PSI



## RIGID LANCES



### Features

Made from high tensile strength cold drawn stainless steel.

### Typical Applications

- Heat exchanger tube cleaning
- Small diameter tube and pipe cleaning

Part Number	Connection Type		O.D.		I.D.		Max. Pressure		Weight	
	Connection 1	Connection 2	in	mm	in	mm	psi	bar	lbs/ft	kg/m
53831 – XX	1/4" HP LH	1/4" HP LH	.245	6.22	.083	2.11	60,000	4,138	.142	.211
54364 – XX	1/4" HP RH	1/4" HP RH	.245	6.22	.083	2.11	60,000	4,138	.142	.211
54554 – XX	1/4" HP LH	1/4" HP RH	.245	6.22	.083	2.11	60,000	4,138	.142	.211
54224 – XX	3/8" HP LH	3/8" HP LH	.368	9.35	.125	3.18	60,000	4,138	.320	.475
54225 – XX	3/8" HP RH	3/8" HP RH	.368	9.35	.125	3.18	60,000	4,138	.320	.475
54556 – XX	3/8" HP LH	3/8" HP RH	.368	9.35	.125	3.18	60,000	4,138	.320	.475
54226 – XX	9/16" HP LH	9/16" HP LH	.553	14.05	.188	4.78	60,000	4,138	.721	1.07
54227 – XX	9/16" HP RH	9/16" HP RH	.553	14.05	.188	4.78	60,000	4,138	.721	1.07
54557 – XX	9/16" HP LH	9/16" HP RH	.553	14.05	.188	4.78	60,000	4,138	.721	1.07
54228 – XX	9/16" HP LH	9/16" HP LH	.553	14.05	.250	6.35	40,000	2,758	.649	.964
54229 – XX	9/16" HP RH	9/16" HP RH	.553	14.05	.250	6.35	40,000	2,758	.649	.964
54558 – XX	9/16" HP LH	9/16" HP RH	.553	14.05	.250	6.35	40,000	2,758	.649	.964

XX- Specify length in feet, up to 25 feet. Ex: 06 = 6 feet in length.

For lengths under 4 feet, see High Pressure Nipples in Fittings, Page E-11.

### Related Items

**SLIM LINE COUPLERS** — See Fittings, Page E-14

**FITTINGS, CONNECTORS, COUPLINGS** — See Fittings, Section E

**FLEXIBLE HOSES** — See Hoses, Pages C-1 & 3

**RIGID LANCE HOLDERS** — See Fittings, Page E-13

### Typically Used With UHPE Nozzles

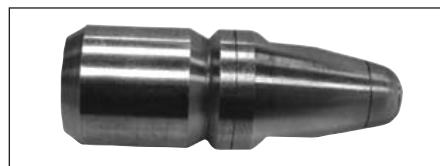

See Pages D-6 & 7

# HOSES & LANCES

40,000 PSI



## RIGID LANCE PRESSURE DROP DATA

